

BINS	Open
-------------	-------------



PPA2212
White Finish



PPA2212B
Black Finish



PPA2212CS
Satin Finish

General Description

- Trash can with plastic ring to hold the bag, made of steel painted in white or black Epoxy or in satin-finished AISI 304 stainless steel.
- Modern and cutting-edge design, designed for a long lifespan and to be vandal-resistant.
- Fully welded, with continuous-traced corners and free of burrs and sharp edges.
- Capacity of 12 L.
- Suitable for washrooms and indoor public areas with medium traffic. Suitable model for collective use.
- Can be freestanding or wall-mounted using 4 screws and anchors. Hardware not included.

Components & Materials

- **PPA2212:** 0.8mm thick steel body, painted white Epoxy finish.
- **PPA2212B:** 0.8mm thick steel body, painted black Epoxy finish.
- **PPA2212CS:** 0.8mm thick AISI 304 stainless steel body, satin finish.
- **BODY:** Single-piece 0.8mm thick steel, welded at the rear.
- **BASE:** 0.8mm thick, welded to the body.
- **SWING RING:** Made of black polypropylene (PP) to hold the bag. Attached to the body with two rivets.

Technical specifications

<i>Dimensions:</i>	360x280x141 mm
<i>Capacity:</i>	12 L
<i>Body thickness</i>	0,8 mm
<i>Weight (empty)</i>	2,29 Kg

Dimensions

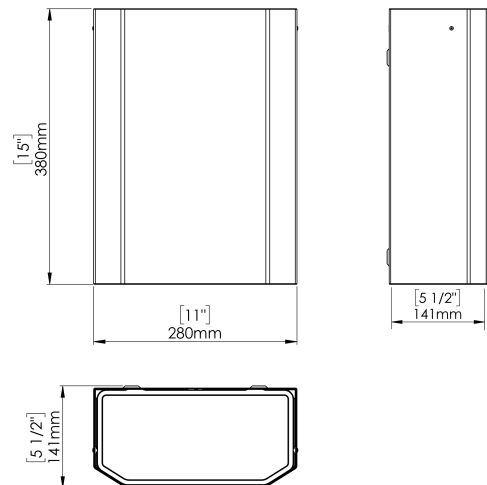

Dimensiones: ±4%

MOUNTING TEMPLAT

Place the garbage bag around the plastic ring. To facilitate bag placement, the plastic ring tilts. With the bag placed on the ring, place it horizontally and secure it in the tabs of the body.